

Stagger Wall

700WSSTG_

1.0



WALL

GENERAL PRODUCT INFORMATION:



These fixtures are intended to be installed utilizing NEC compliant junction boxes.

This product is suitable for damp locations.

This product can be dimmed with most LED compatible ELV and Triac dimmers.

This instruction shows a typical installation.

CAUTION - RISK OF FIRE
This product must be installed in accordance with the applicable installation code by a person familiar with the construction and operation of the product and the hazards involved.
Use minimum 90°C supply conductors.

SAVE THESE INSTRUCTIONS!

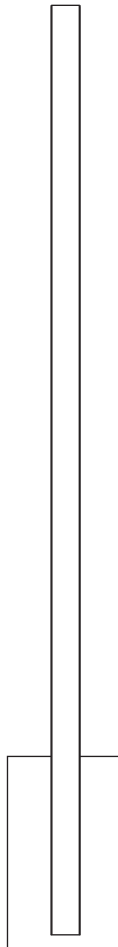

7400 Linder Ave., Skokie, IL 60077
T 847.410.4400 | F 847.410.4500
www.techlighting.com

Install the Insert

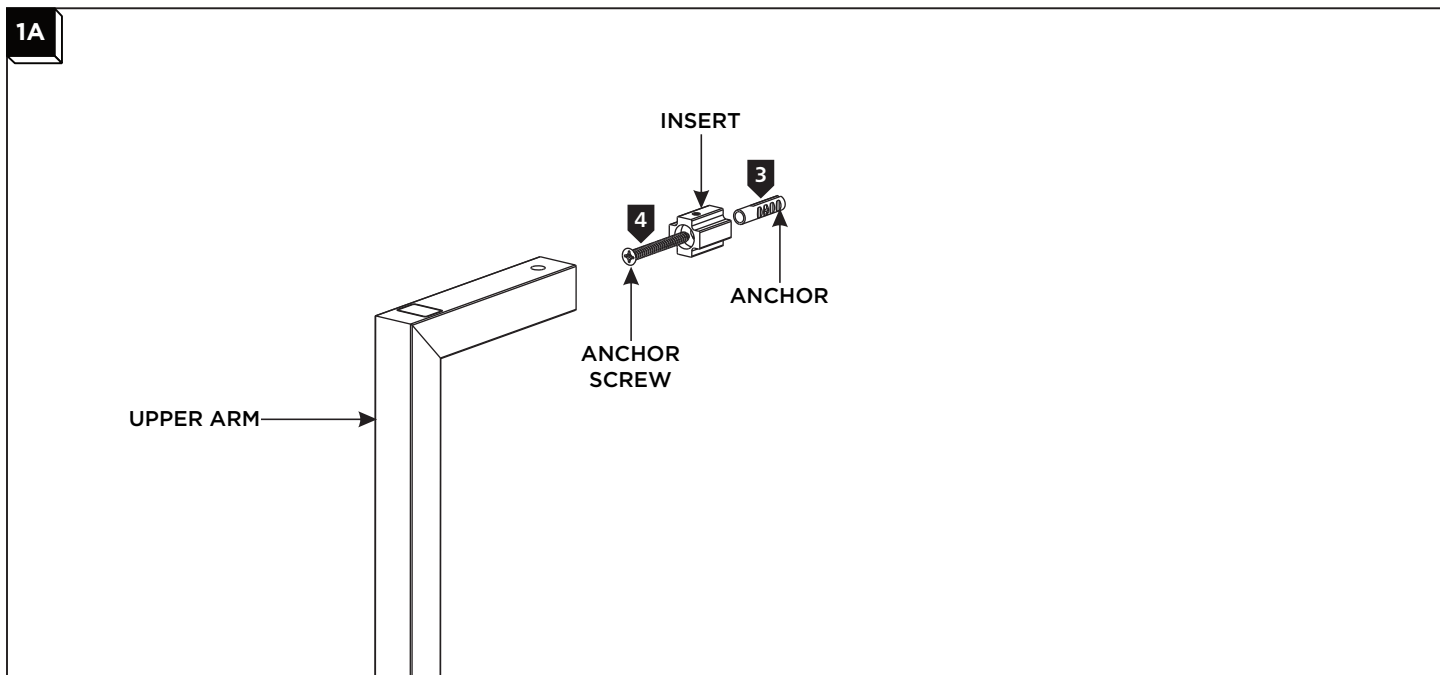

- 1 Place the arm on the wall with the junction box is located.
- 2 Make sure the arm is leveled and mark the top of the arm location.
- 3 Drill an appropriate sized hole and install the anchor into the wall.
- 4 Place the insert on the wall over the anchor and secure it in place with an anchor screw.

**For standard installation, go to Section 2A.
For plaster plate installation, Skip to Section 3A.**

Install the Fixture

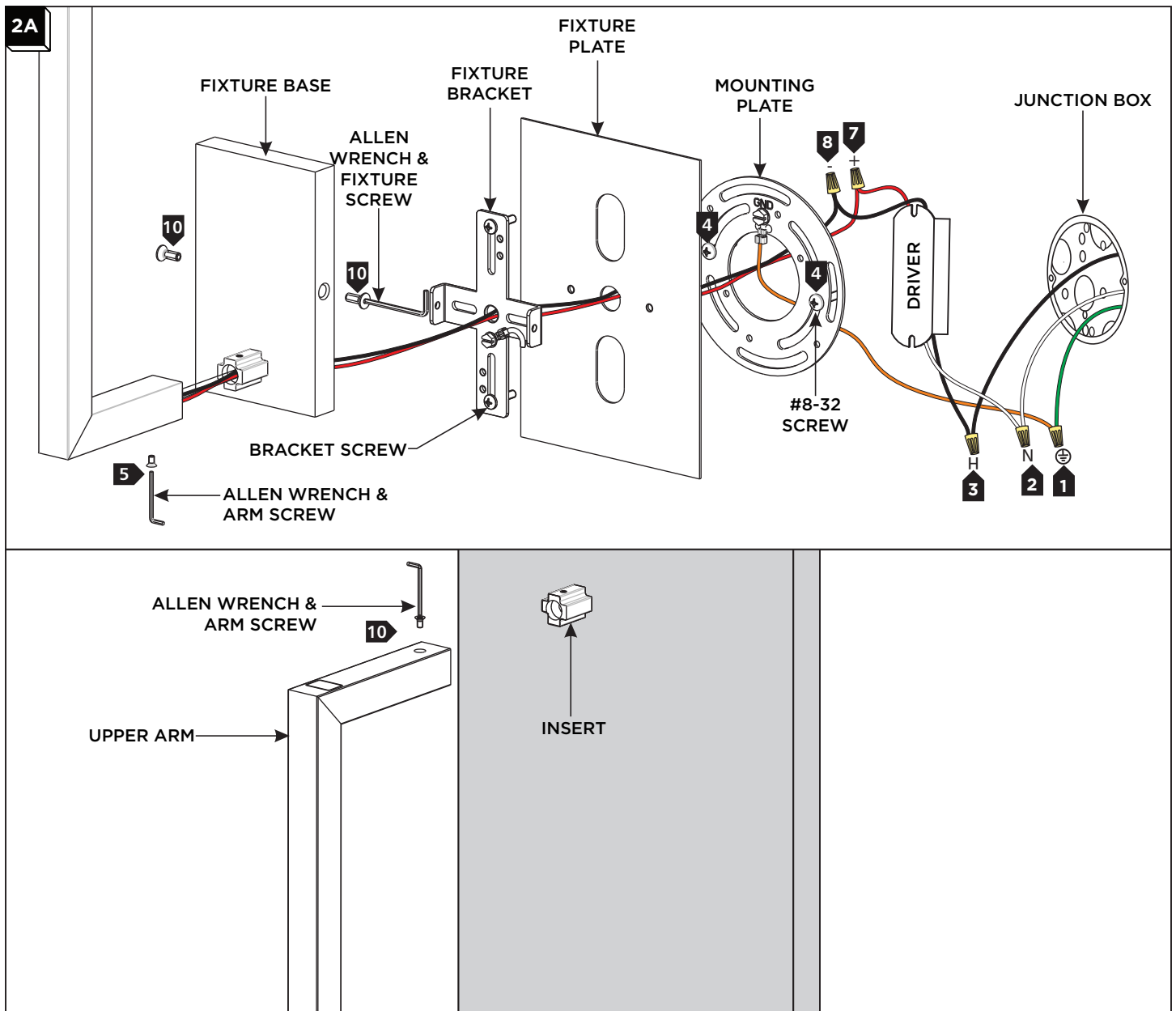

- 1 Connect the fixture to a suitable ground in accordance with local electrical codes.
- 2 Connect the white input driver wire to the neutral power line with a wire nut.
- 3 Connect the black input driver wire to the hot power line with a wire nut.
- 4 Properly place the driver/wire nut connections into the junction box and install the mounting plate to the junction box with the two provided #8-32 screws.
- 5 Feed the fixture wires through the fixture base, then secure the lower arm to the fixture base with the Allen screw using the provided Allen wrench.
- 6 Feed the fixture wires through the fixture bracket and goof plate.
- 7 Connect the negative (-) fixture wire to the negative (-) driver output wire with a wire nut.
- 8 Connect the positive (+) fixture wire to the positive (+) driver output wire with a wire nut.
- 9 Properly place the wire nut connections into the junction box, install the fixture bracket and goof plate to the mounting plate with the two provided bracket screws.
- 10 Install the fixture base onto the fixture bracket and secure it in place with the Allen screws using the provided Allen wrench. Secure the upper arm to the insert with the Allen screw using the provided Allen wrench.

Install the Fixture

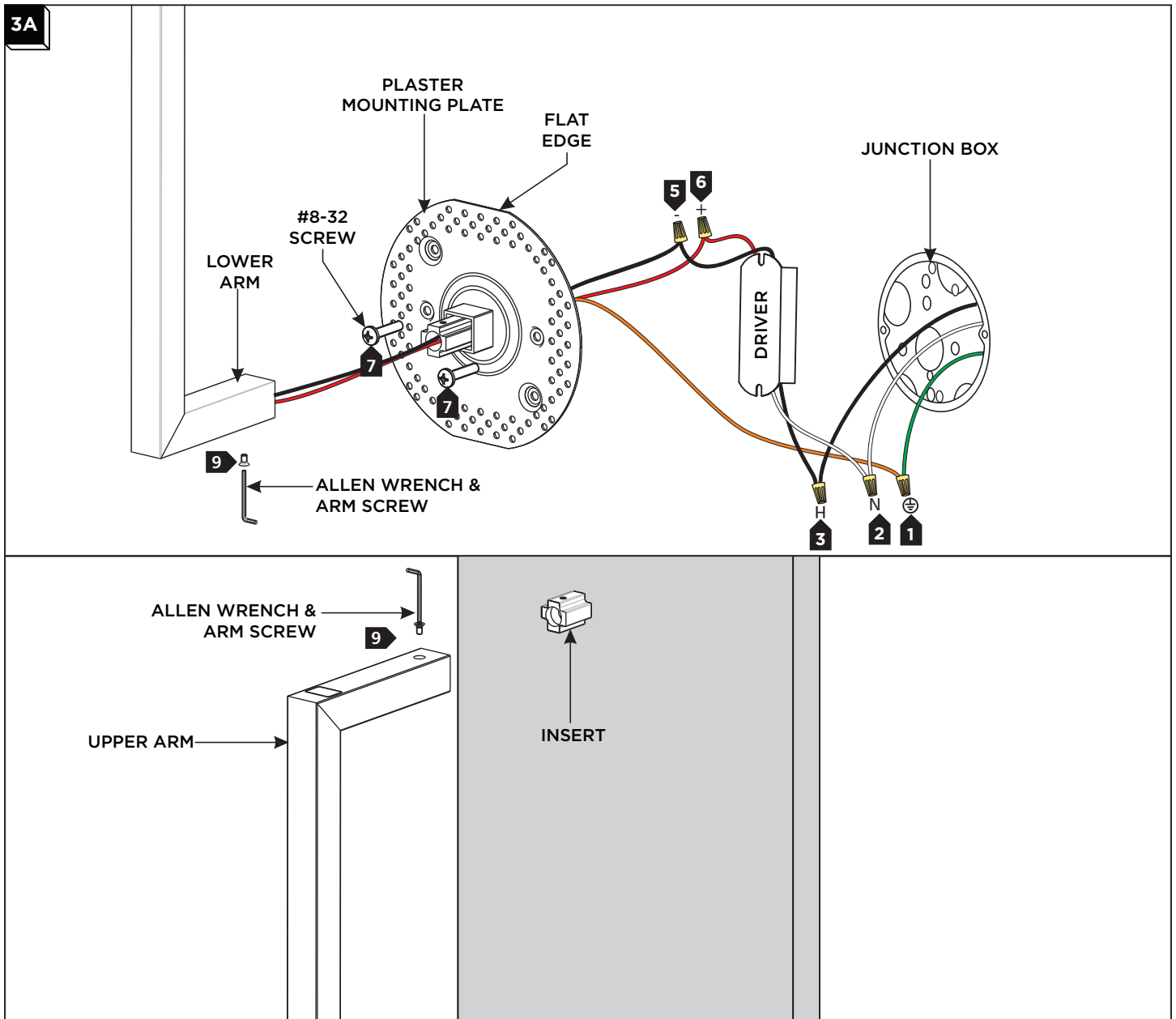

- 1 Connect the fixture to a suitable ground in accordance with local electrical codes.
- 2 Connect the white input driver wire to the neutral power line with a wire nut.
- 3 Connect the black input driver wire to the hot power line with a wire nut.
- 4 Feed the fixture wires through the plaster mounting plate.
- 5 Connect the negative (-) fixture wire to the negative (-) driver output wire with a wire nut.
- 6 Connect the positive (+) fixture wire to the positive (+) driver output wire with a wire nut.
- 7 Properly place the driver, all wires, and wire nut connections into the junction box and install the plaster mounting plate to the junction box with the two provided #8-32 screws. **NOTE: Make sure that the plaster mounting plate is parallel with the floor and ceiling using the flat edges on the top and bottom of the plaster mounting plate.**
- 8 Plaster the plaster mounting plate to match the wall finish.
- 9 Mount the mount the lower arm onto the plaster mounting plate, and secure it in place by tightening the Allen screw using the provided Allen wrench. Secure the upper arm to the insert with the Allen screw using the provided Allen wrench.